

Low-Noise Type Duct Ventilating Fan 静音型管道送风机

The low-noise type duct ventilating fan is an ideal equipment for ventilation in houses, villas, offices, conference rooms, shopping malls, hotels, restaurants and other public places.

It can be efficiently used with connection to ducts for air supply and exhaust, perfectly keeping the indoor air clean and fresh.

The low-noise type duct ventilating fan inlet and outlet makes installation with ducts much more easier and more space-saving and even extremely lower noise.

静音型管道送风机是现代居住场所必备的通风设备，它能有效地进行送风换气，令室内空气清新、干净，适用于家庭、别墅、办公楼、会议室、商场、宾馆、酒楼或其它公共场所等。

静音型管道送风机设计进出风管口为直出直入方式，不需弯曲，故安装方便、外形美观，占空间少、噪音低。

External Dimensions 外形尺寸图

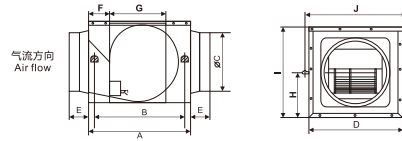

Dimension Table 尺寸表

Units 单位:mm

| 型号 Model No. | A | B | C | D | E | F | G | H | I | J | K | 管口尺寸 Duct Size (mm) |
|-----------------|-----|-----|-----|-----|----|-----|-----|-------|-----|-----|---|---------------------------|
| DPT10-12B | 340 | 298 | 95 | 240 | 65 | 68 | 210 | 100 | 200 | 285 | / | Φ100 |
| DPT10-23B | 340 | 298 | 95 | 240 | 65 | 68 | 210 | 100 | 200 | 285 | / | Φ100 |
| DPT15-32B | 340 | 298 | 150 | 240 | 75 | 53 | 230 | 120 | 240 | 285 | / | Φ150 |
| DPT15-42B | 390 | 348 | 150 | 270 | 75 | 58 | 265 | 140 | 280 | 315 | / | Φ150 |
| DPT20-54B | 420 | 378 | 200 | 340 | 65 | 64 | 265 | 140 | 280 | 385 | / | Φ200 |
| DPT20-54C | 490 | 448 | 200 | 370 | 65 | 58 | 304 | 160 | 320 | 415 | / | Φ200 |
| DPT20-65B | 520 | 478 | 200 | 400 | 65 | 74 | 344 | 182.5 | 365 | 445 | / | Φ200 |
| DPT25-76B | 590 | 548 | 250 | 400 | 75 | 74 | 364 | 190 | 380 | 445 | / | Φ250 |
| DPT25-76C | 590 | 548 | 250 | 400 | 75 | 74 | 364 | 190 | 380 | 445 | / | Φ250 |
| DPT25-86C | 660 | 618 | 250 | 480 | 75 | 107 | 375 | 210 | 420 | 525 | / | Φ250 |
| DPT25-86B | 660 | 618 | 250 | 480 | 75 | 107 | 375 | 210 | 420 | 525 | / | Φ250 |

Low-Noise Type Duct Ventilating Fan 静音型管道送风机

Electrical Ratings 技术参数

| 型号 Model No. | 额定电压/频率/相数 Rated Voltage/Frequency/Phase | 风轮直径 Impeller Diameter (mm) | 功率 Power (W) | 转速 Rotating Speed (R.P.M.) | 风量 Air Volume (m ³ /h) | 静压 Static Pressure (Pa) | 噪音 Noise (dB) | 电机绝缘等级 Insulation Class | 净重 Net Weight (kg) |
|-----------------|---|--------------------------------------|--------------------|-------------------------------------|--|----------------------------------|---------------------|----------------------------|-----------------------------|
| DPT10-12B | 220V~150Hz/1Ph | 120 | 20 | 960 | 100 | 80 | 20 | E | 5.4 |
| DPT10-23B | | 120 | 37 | 1350 | 180 | 163 | 23 | | 6.8 |
| DPT15-32B | | 150 | 55 | 1240 | 360 | 116 | 27 | | 8.1 |
| DPT15-42B | | 180 | 125 | 1360 | 500 | 191 | 29 | | 10.3 |
| DPT20-54B | | 180 | 157 | 1249 | 770 | 204 | 35 | | 12.2 |
| DPT20-54C | | 200 | 187 | 1250 | 920 | 249 | 37 | | 15.0 |
| DPT20-65B | | 230 | 275 | 1270 | 1200 | 348 | 41 | | 20.9 |
| DPT25-76B | | 250 | 405 | 1040 | 1700 | 404 | 43 | | 25.5 |
| DPT25-76C | | 250 | 535 | 1200 | 1900 | 440 | 46 | | 26.5 |
| DPT25-86C | | 280 | 780 | 1370 | 2310 | 518 | 46 | | 36.7 |
| DPT25-86B | 380V~150Hz/3Ph | 280 | 800 | 1380 | 2600 | 536 | 46 | 36.7 | |

Performance Curve 性能曲线图

A: DPT10-12B B: DPT10-23B C: DPT15-32B
 D: DPT15-42B E: DPT20-54B F: DPT20-54C
 G: DPT20-65B H: DPT25-76B I: DPT25-76C
 J: DPT25-86C K: DPT25-86B

